

1

Land At Junc Foredown Road & Fox Way

BH2021/00780



**Brighton & Hove
City Council**

Application Description

- Outline application with all matters reserved apart from access for erection of 14no. two and three bedroom houses with associated car and cycle parking, changes to vehicular and pedestrian access.

Map of application site



Existing Location Plan

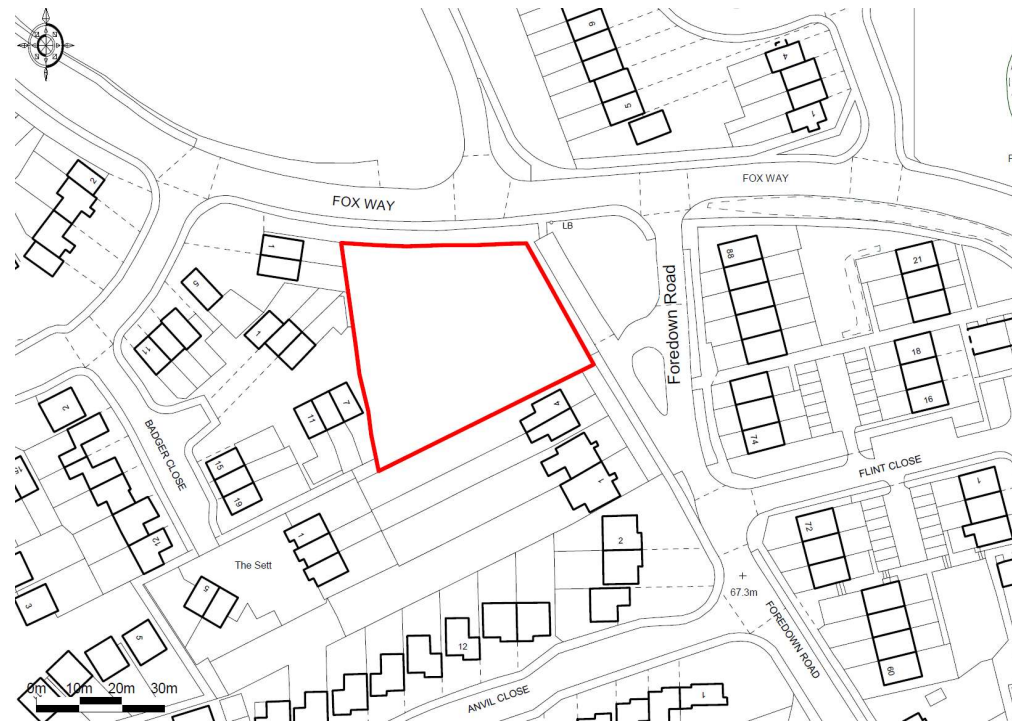

20234/99



Proposed Location Plan



5

FWP/SR/2001 G



Aerial photo of site



Brighton & Hove
City Council

3D Aerial photo of site



Street photos of site



Street photos of site



Brighton & Hove
City Council

Photos of site



Photos of site



Brighton & Hove
City Council

Photos of site



Brighton & Hove
City Council

Proposed Access Details

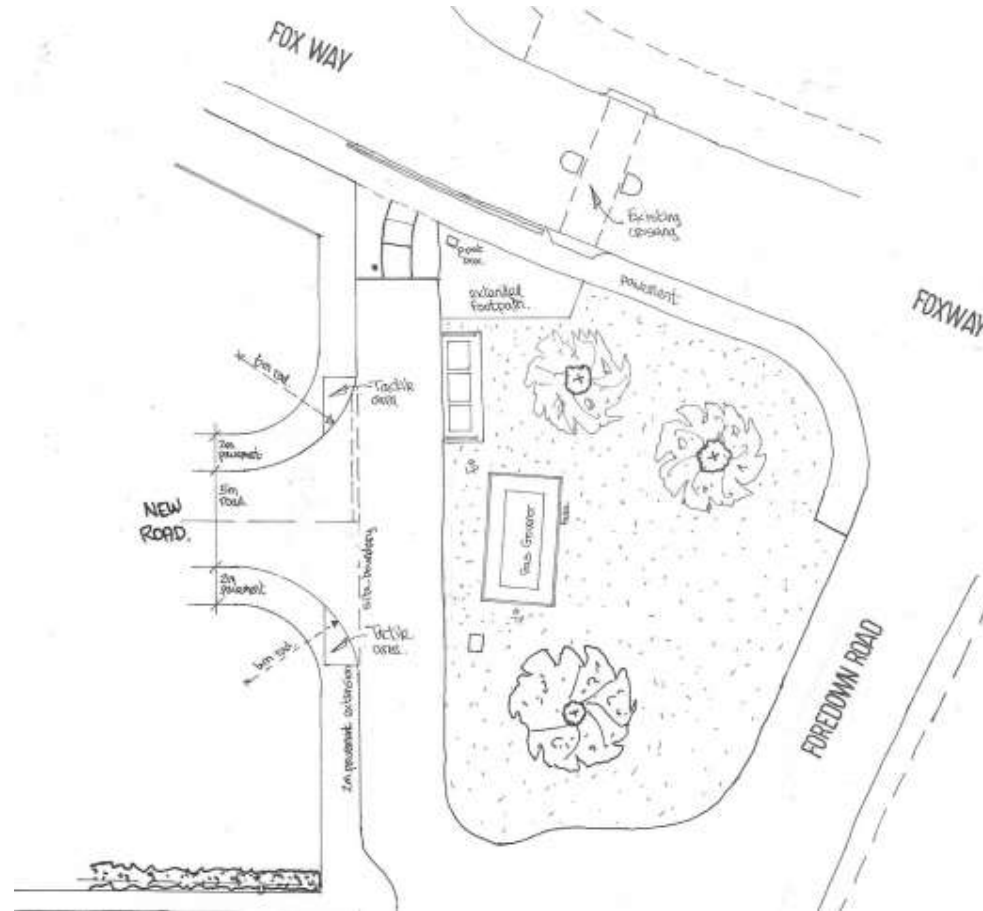

13

20234/21B



Feasibility Site Layout (info only)



20234/22B

Key Considerations in the Application

- Principle of development
- Unit mix
- Density
- Site access



Brighton & Hove
City Council

Conclusion and Planning Balance

- Would provide 14 units of residential accommodation in Portslade - principle of contributing to housing need given great weight;
- Unit mix and density considered acceptable;
- No adverse impact on highway safety anticipated.

The proposed development is therefore recommended for **Approval**.